

STEP 1: MOUNT THE ANALYZER



Mount the MODEL 3010BX to a wall or bulkhead using (4) 1/4" screws.

OR



Mount the unit to a 2-inch pipe using 1/4" x 2" U-brackets with 1/4" nuts.

WARNING!

NEVER MOUNT THE ANALYZER ABOVE A HEAT SOURCE, SUCH AS A CATALYTIC HEATER.



STEP 2: SETUP THE ELECTRICAL CONNECTIONS



First, install the conduit unions between the explosion-proof housing of the Analyzer and electrical seal-offs. DO NOT fill the electrical seal-offs yet.



DANGER!

If you are using DC Power and only a single conduit, YOU MUST INSTALL A STEEL PLUG IN THE UNUSED 1/2" NPT. FAILURE TO DO SO WILL VIOLATE ALL SAFETY REQUIREMENTS AND POTENTIALLY RESULT IN AN EXPLOSION!



Second, pull wires for power and the alarms through the 1st conduit and connect to their proper terminals.



Third, pull wires for ANALOG OUTPUTS and RS485 communication through the 2nd conduit and connect to their proper terminals.

PROTECTIVE EARTH GROUND LUG



Next, connect the Analyzer's Protective Earth Ground, located on the Back Panel, to a Quality Earth Ground (such as one shown above).

IMPORTANT

Analyzer must be connected to a Quality Protective Earth Ground for safety and the highest level of RFI protection.

STEP 3: ESTABLISH THE GAS CONNECTION

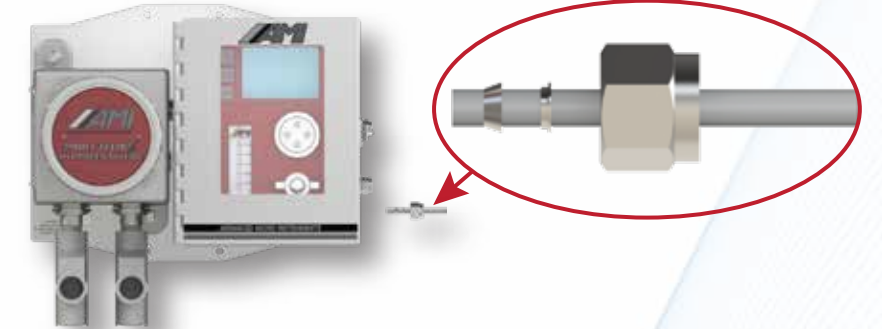

First, take a 1/4" stainless steel tubing, the supplied compression nut and ferrule set and properly orientate at one end. Then, connect to the SAMPLE GAS INLET PORT.

Second, repeat the above steps for the EXHAUST PORT.

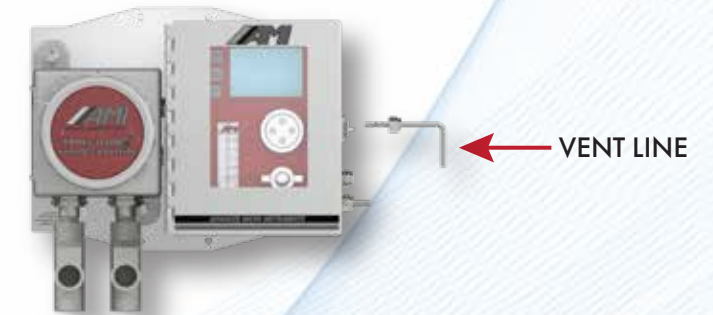

VENT LINE

CAUTION!

VENT LINE needs to run slightly down and to a safe area outside. VENT LINE should not be combined with other exhaust lines.



METERING VALVE

Last, initiate the **GAS FLOW** by completing these steps:

- Apply a gas pressure between ~20 to 100 psig.
- Check all fittings for leaks back to the Sample Tap while using SNOOP®. DO NOT USE A SPRAY BOTTLE.
- Slowly turn the METERING VALVE until the FLOW METER reads ~1.0 SCFH.

SPECIAL MESSAGE FROM ADVANCED MICRO INSTRUMENTS

Thank you for purchasing this **MODEL 3010BX** for your Trace H₂S measurement needs. This permanent Trace H₂S Analyzer is the industry's most advanced and contains patented designs and innovations. You will find that it will deliver the highest levels of performance, reliability and a full suite of desirable features.

If you have any questions, contact AMI at 714.848.5533 or www.amio2.com.

ACCESSORIES

Our permanent mount Analyzers are complemented by a full range of accessories that precondition the sample gas, protect the Analyzer and assist sample gas flow.



DEMISTER



ANALYZER
GUARDIAN
with DEMISTER



ANALYZER
GUARDIAN



ANALYZER
GUARDIAN
WITH
REGULATOR



EXTREME WEATHER
ENCLOSURE



FIXED
SAMPLE PUMP

IMPORTANT ANALYZER INFORMATION

- The Analyzer is shipped with an H₂S sensor already installed. It is located behind the Cell Cap.
- The Analyzer must be calibrated every time a new sensor is inserted or replaced. **NO EXCEPTIONS!**
- Calibration should be performed with SPAN GAS.
- Calibration should be performed every 6 months to verify proper Analyzer performance.
- The Quick Start Guide is **NOT A SUBSTITUTE** for the Operator Manual. Refer to the Operator Manual for full details on the installation of this Analyzer.

CRITICAL 'MUST DO' CHECKLIST

- Only nuts and ferrules, supplied with this Analyzer, were used in ALL YOUR GAS CONNECTIONS. No substitutes.
- Analyzer must be connected to a Quality Protective Earth Ground for safety and RFI protection.
- COMMAND CENTER Software is uploaded into your laptop computer (shipped with your Analyzer or it can be downloaded at www.amio2.com).
- External power is **NOT APPLIED** to the Analog Output Terminals. Note: Analog Output Terminals are loop-powered.



MODEL 3010BX

QUICK START GUIDE



 **225 Paularino Avenue
Costa Mesa, CA 92626**

 **714.848.5533**

 **www.amio2.com**